

How to Configure an Android Device to Access Your Lynden School District Email

Go to your Apps and Open Email App

1. Enter your District Email and Password

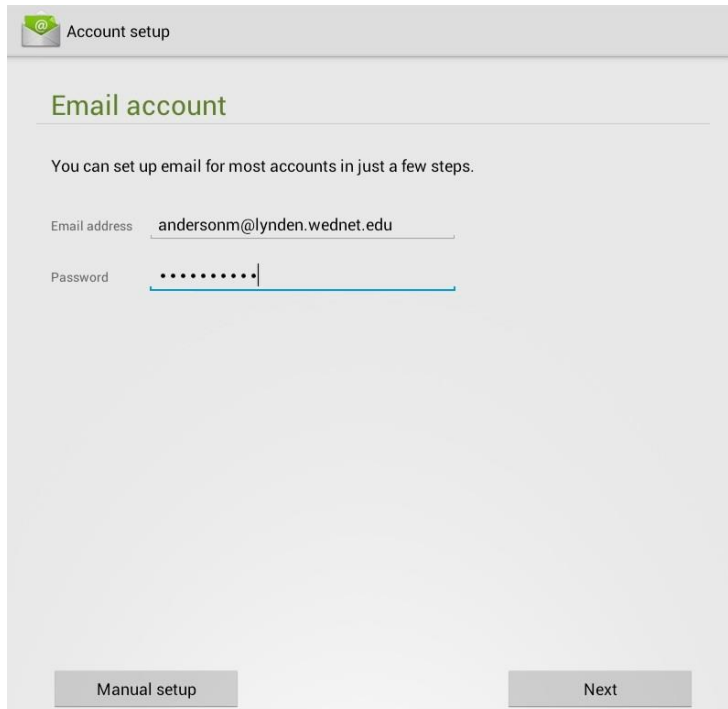

Account setup

Email account

You can set up email for most accounts in just a few steps.

Email address:

Password:

Manual setup Next

a. Select **Next**

b. Select **Exchange**

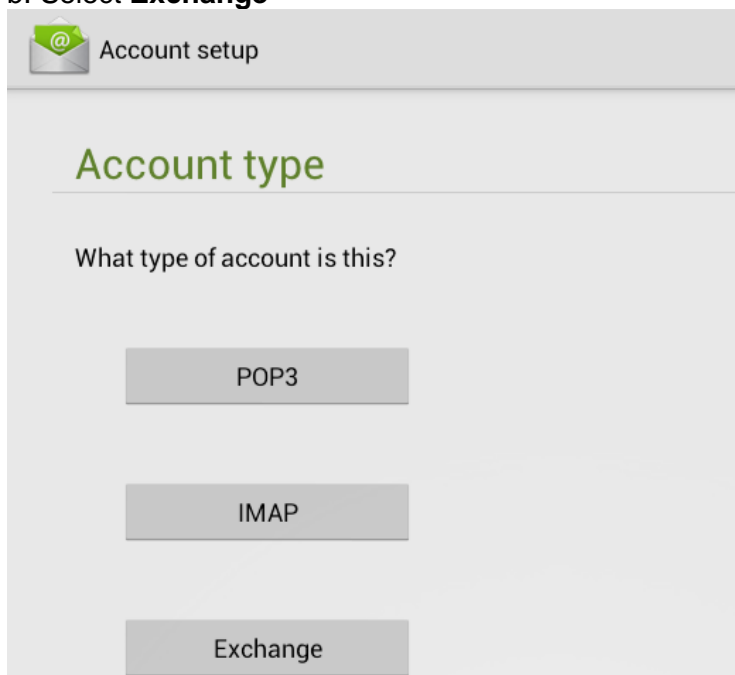

Account setup

Account type

What type of account is this?

POP3

IMAP

Exchange

How to Configure an Android Device to Access Your Lynden School District Email

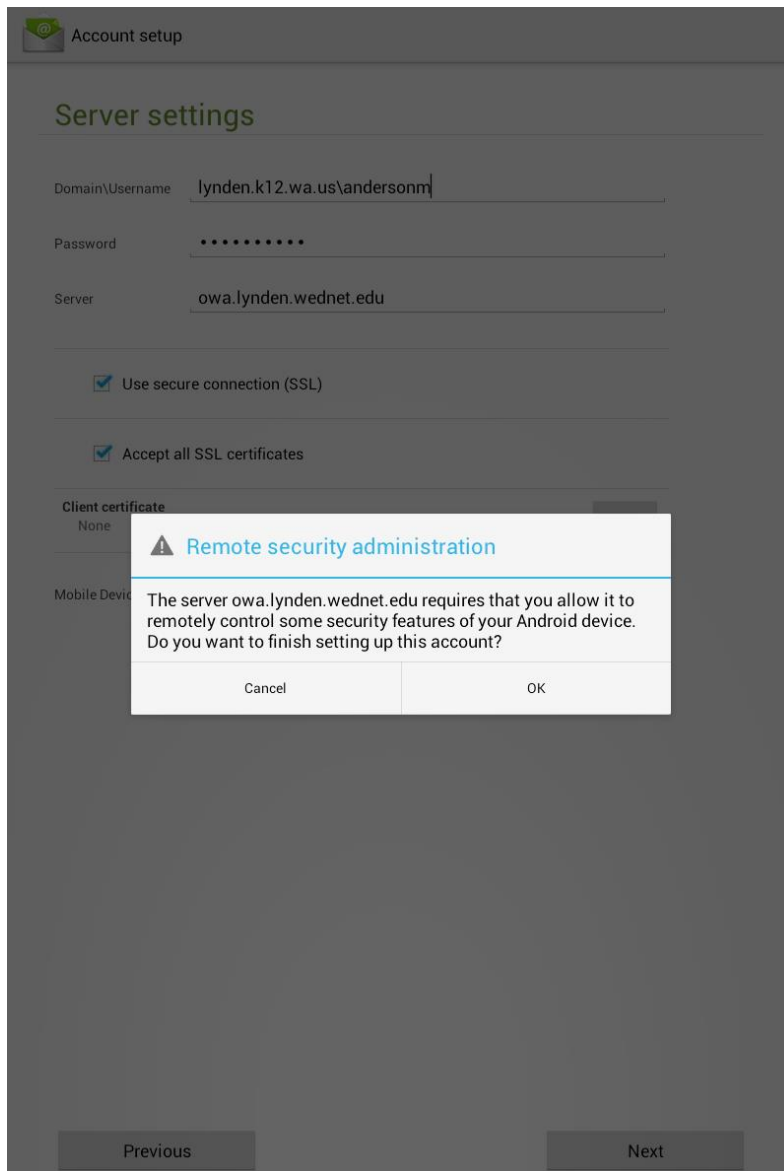

2. Enter lynden.k12.wa.us\Username
 - a. Server = owa.lynden.wednet.edu
 - b. Check Use secure connection (SSL)
 - c. Check Accept all SSL certificates
 - d. Select Next
 - e. Press OK on Remote security administration prompt

How to Configure an Android Device to Access Your Lynden School District Email

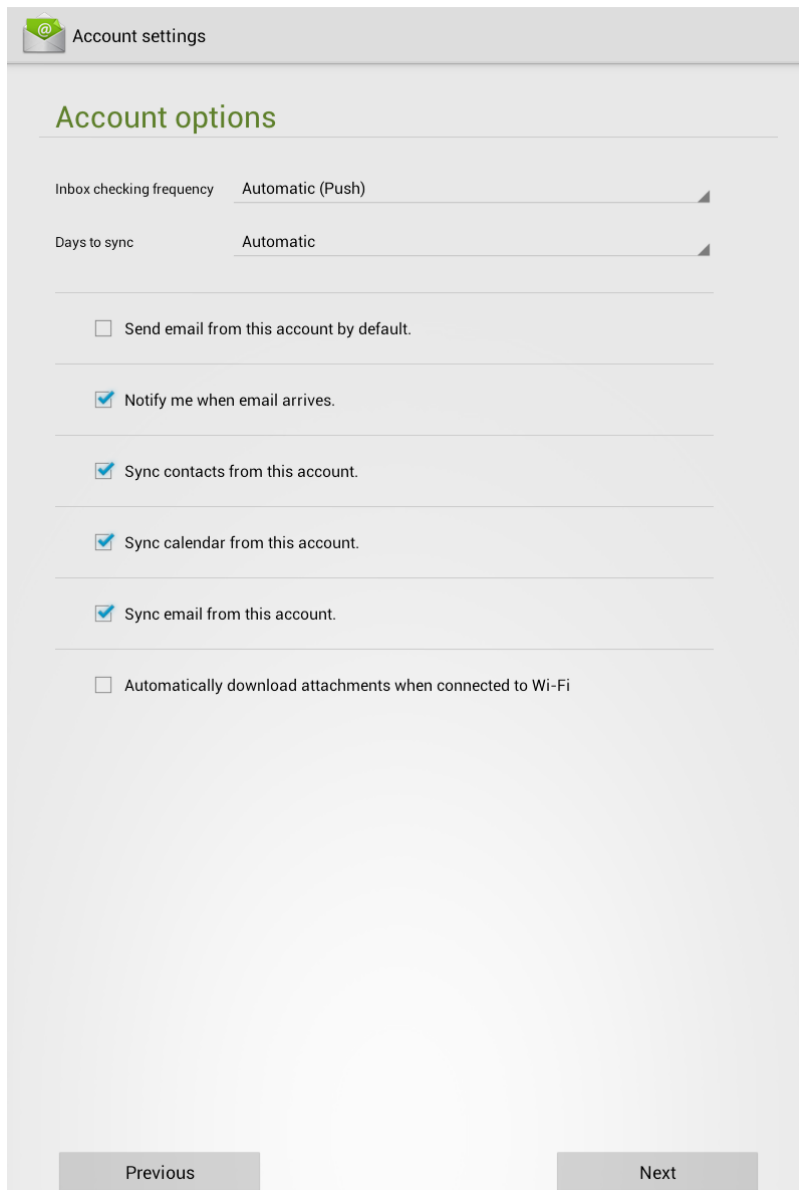

- f. Select desired sync options
- g. Select Next

How to Configure an Android Device to Access Your Lynden School District Email

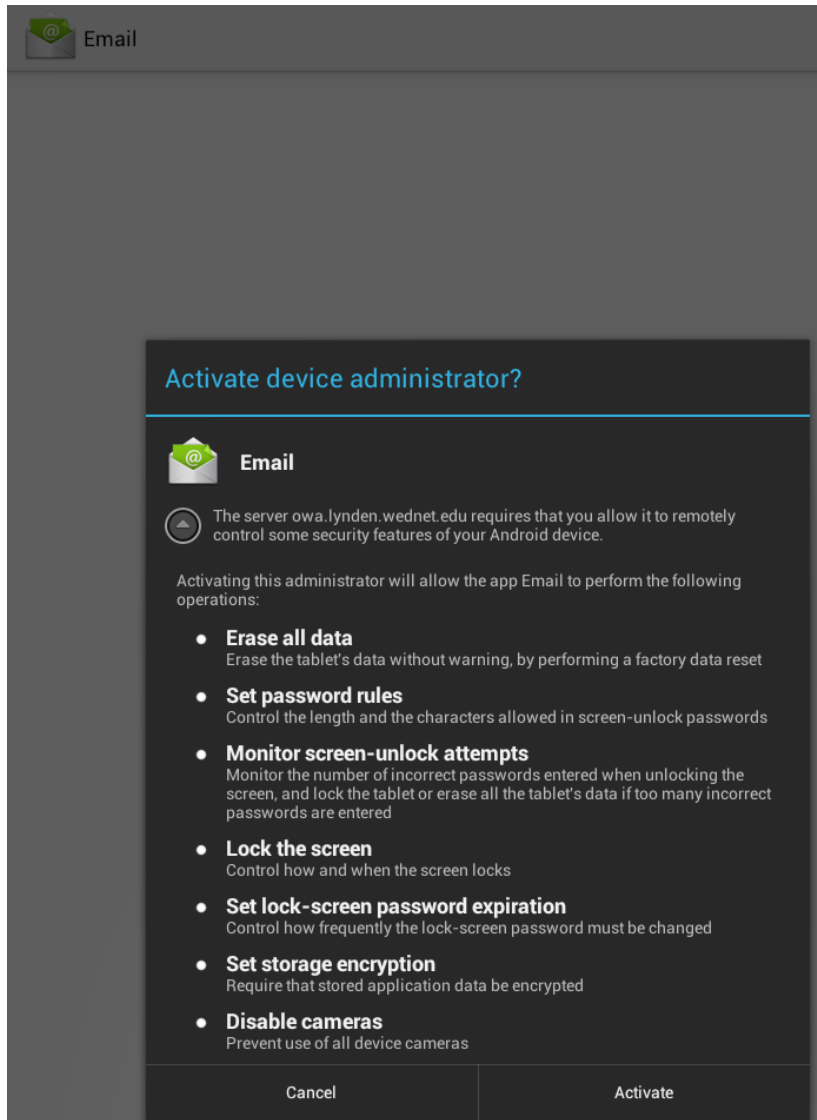

h. Press Activate on Activate device administrator prompt

***You must use the network called "LION-General" only for all Android Devices when on the School District Network